

# VISIO RONDO 1x26/2x26

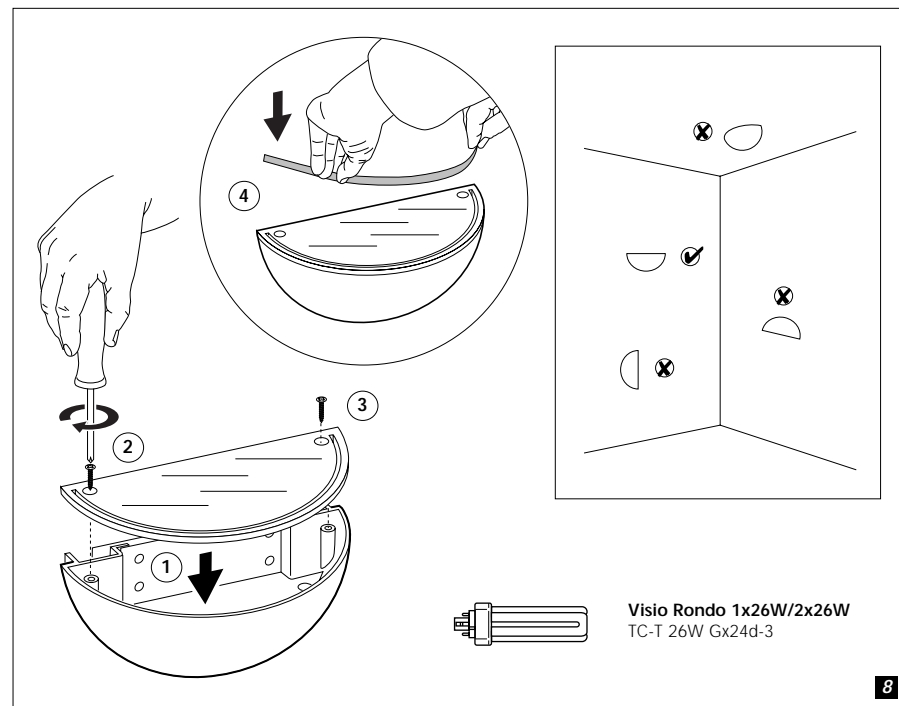
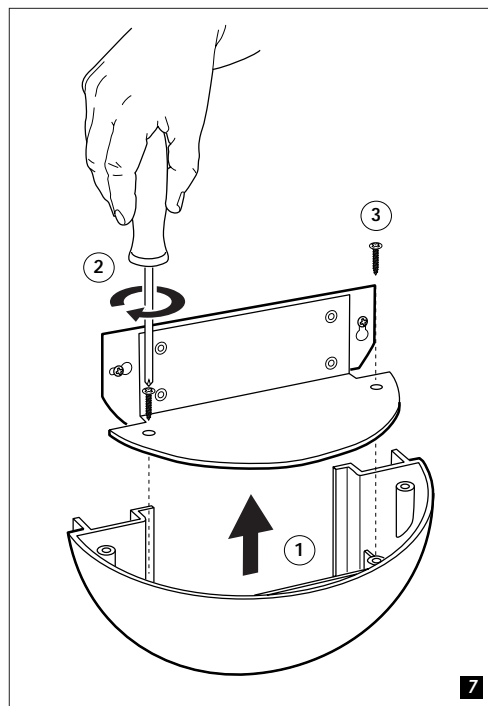
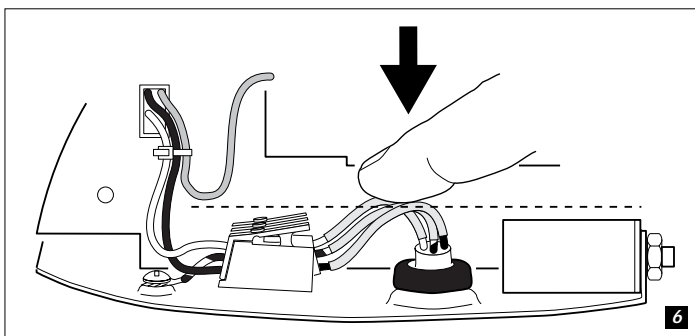
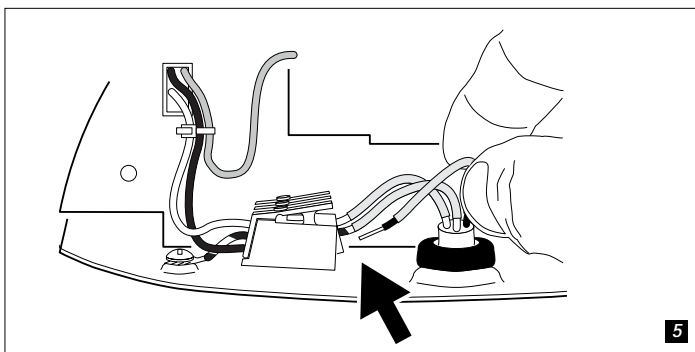
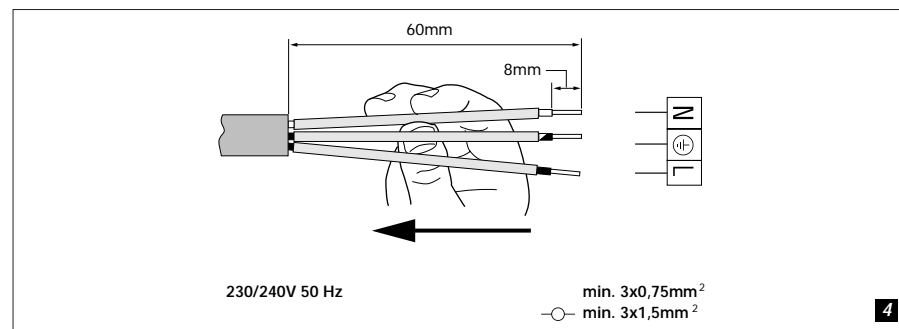
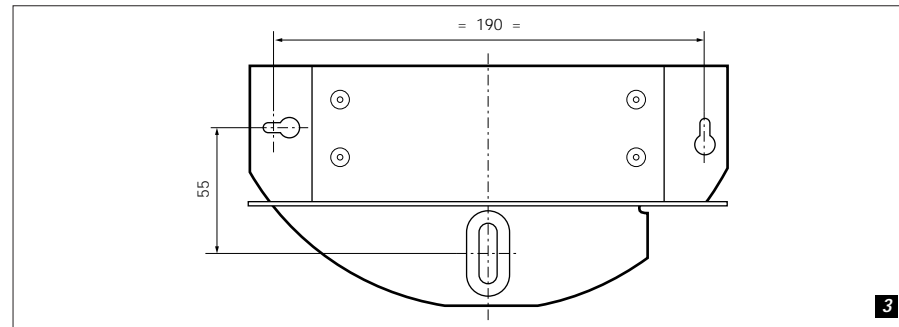
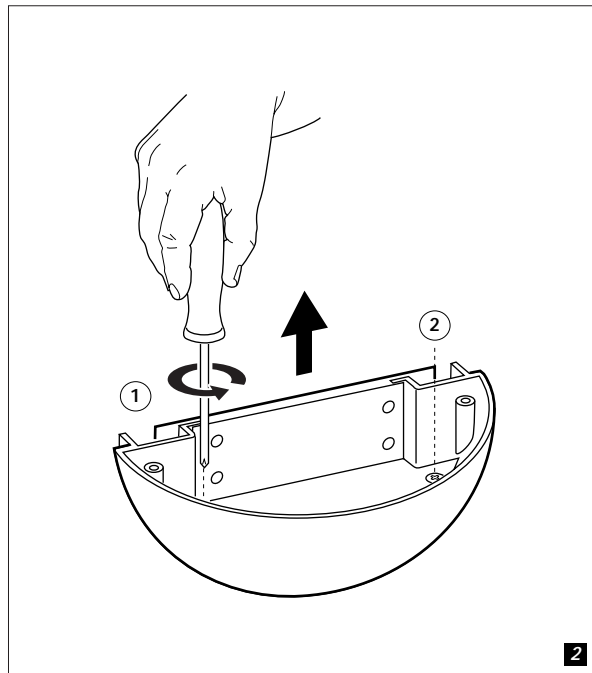
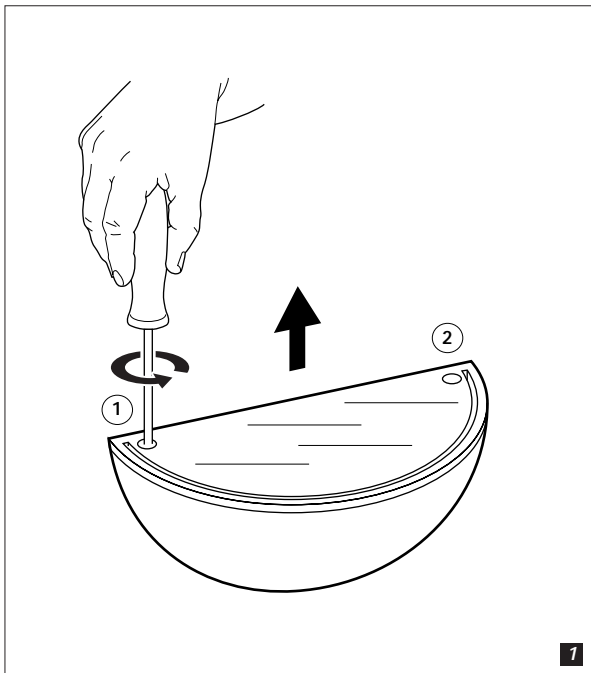

wandarmaturen  
wall Luminaires  
appliques destinées  
Wandleuchten  
luminarias de pared  
väggarmaturer  
veggarmatur  
vægarmatur  
on seinään kiinnitettävä  
valaisin  
apparechio a muro  
armadura de parede

## Nederlands

Klasse I Opbouwarmatuur voor TC-T 26W Gx24d-3.

Ontworpen volgens EN-60 598 230-240V 50Hz.

De armatuur mag niet worden afgedekt.

Alleen geschikt voor vaste installatie op de wand **(8)**.

Gebruik uitsluitend het voorgeschreven lamptype en let op het maximale Wattage. Zie etiket in armatuur.

 Geschikt voor montage op normaal brandbare oppervlakken.

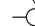
 Gebruik voor doorlussen minimaal 1,5 mm<sup>2</sup>.

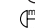
 (0,2m) Neem minimum afstand tussen armatuur en verlichte voorwerpen in acht.

## English

Class I Surface mounted luminaire designed for TC-T 26W Gx24d-3.

Designed to conform EN-60 598 230-240V 50Hz.

The fitting should not be covered.

Only suited for fixed installation to the wall **(8)**.

Only use lamps of the correct type and rating (see label).

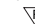
 Suitable for mounting on flammable surfaces.

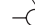
 Use for connection in parallel min. 1.5 mm<sup>2</sup>.

 (0,2m) Minimum distance between the lamp and lit objects in metres.

## Français

Classe I Applique à TC-T 26W Gx24d-3.

Conçue selon EN-60 598 230-240V 50Hz.

Ne pas recouvrir le produit.

Produit adapté uniquement pour une installation fixe pour un montage mural **(8)**.

Utiliser uniquement des lampes du type prescrit; ne pas dépasser la puissance indiquée (voir étiquette).

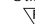
 Convient pour le montage sur surfaces normalement inflammables.

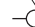
 Utiliser pour connexion en parallèle min. 1,5 mm<sup>2</sup>.

 (0,2m) Distance minimum entre la lampe et une surface normalement inflammable.

## Deutsch

Klasse I Aufbau-strahler für TC-T 26W Gx24d-3.

Konzipiert entsprechend EN-60 598 230-240V 50Hz.

Die Leuchte darf nicht abgedeckt werden.

Nur geeignet für feste Montage. Nicht geeignet für Bodenmontage **(8)**.

Auf den richtigen Typ und Anschlußwert achten (vgl. Etikett).

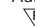
 Zugelassen für Montage auf normal brennbarem Material.

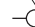
 Für Parallelschaltung min. 1,5 mm<sup>2</sup>.

 (0,2m) Mindestabstand zwischen Leuchte und angestrahlem Gegenstand in Metern.

## Español

Clase I Luminaria adosada TC-T 26W Gx24d-3.

Diseñadas conforme EN-60 598 230-240V 50Hz.

No cubrir el aparato con ningún.

Sólo apropiado para instalación fija para montaje en la pared **(8)**.

Utilizar exclusivamente lámparas del tipo y potencia correctos.

 Apropriada para su instalación sobre superficies inflamables.

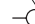
 Por conectar en paralelo min. 1,5 mm<sup>2</sup>.

 (0,2m) Para prevenir riesgo de incendio: mantener una distancia mínima en metros desde la lámpara a los objetos iluminados.

## Svenska

Klass I Uppbyggningsarmatur för TC-T 26W Gx24d-3.

Utvecklats enligt EN-60 598 230-240V 50Hz.

Armaturen får inte täckas över.

Endast lämpad för fast installation för väggmontering **(8)**.

Användas endast ljuskällor av rätt typ och storlek (se etikett).

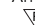
 Lämplig att installera på eller i normalt brännbart material.

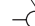
 Använd för parallellkoppling min. 1,5 mm<sup>2</sup>.

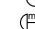
 (0,2m) Symbolen anger minsta avstånd mellan lampa och belyst yta.

## Norsk

Klasse I Oppbyggningsarmatur for TC-T 26W Gx24d-3.

Utformet i samsvar med EN-60 598 230-240V 50 Hz.

Armaturen må ikke tildekkes.

Kun konstruert for fast installasjon monteres på vegg **(8)**.

Påse at det nyttes korrekt lyskilde og at max W ikke overskrides.

 For montering på normalt brennbare flater.

 Bruk for parallellkopling min. 1,5 mm<sup>2</sup>.

 (0,2m) For må unngå brannfare må det være en minimumavstand på meter mellom lampen og det belyste punktet.

## Dansk

Klasse I Påbyggningsarmatur til TC-T 26W Gx24d-3.

Designet i henhold til EN-60 598 230-240V 50Hz.

Armaturer må ikke tildækkes.

Kun beregnet til fast installation til vægmontering **(8)**.

Anvend kun den korrekte lampetype (se mærkat på armaturet).

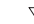
 Ikke monteres på almindeligt brændbart underlag.

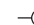
 Anvendelse for parallellforbindelse 1,5 mm<sup>2</sup>.

 (0,2m) Mindste afstand til belyste genstande skal overholdes.

## Suomenkielinen

I-luokan Sisä-asennusvalaisin TC-T 26W Gx24d-3.

Rakennettu EN-60 598:n mukaisesti 230-240V 50Hz.

Valaisinta ei saa peittää.

Sopii vain kiinteään asennukseen seinäasennukseen **(8)**.

Käytä oikeata lampputyyppiä, älä ylitä ilmoitettua maksimitehoa.

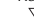
 Voida asentaa puupinnoille.

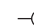
 Käytä rinnankytkennässä vähintään 1,5 mm<sup>2</sup> johtoa.

 (0,2m) Vähimmäisetäisyys valaisimen ja helposti syttyvien pintojen välillä.

## Italiano

Classe I Apparecchio da soffitto da utilizzare con TC-T 26W Gx24d-3.

Progettato a norma EN-60 598 230-240V 50Hz.

L'apparecchio non deve essere coperto da.

Adatto solo per impianti fissi al montaggio a parete **(8)**.

Devono essere utilizzate solo lampade del tipo corretto e dei valori previsti (vedi etichetta).

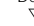
 È idoneo al montaggio su superfici con normale grado di infiammabilità.

 Usare per installazione in parallelo min. 1,5 mm<sup>2</sup>.

 (0,2m) Distanza minima tra la lampada e la superficie illuminata, in metri.

## Português

Classe I Armadura de montar à fac para TC-T 26W Gx24d-3.

Concebido conforme as normas EN-60 598 230-240V 50Hz.

A armadura não pode ser coberta com.

Só é apropriada para instalação fixa para montagem na parede **(8)**.

Devem ser aplicadas somente lâmpadas do tipo e potência correctas (siga as instruções).

 Adequado para montar em superfícies normalmente inflamáveis.

 Para conectar em paralelo, min. 1,5 mm<sup>2</sup>.

 (0,2m) Considerar uma distância mínima em metros entre as armaduras e os objectos iluminados, conforme o indicado na armadura.