

- 2037296 - 5.60Kg
- 2037297 - 7.60Kg
- 2037298 - 5.60Kg
- 2037300 - 7.60Kg
- 2038964 - 5.70Kg
- 2038965 - 7.70Kg
- 2038966 - 5.70Kg
- 2038967 - 7.70Kg
- 2041211 - 5.60Kg
- 2041212 - 5.60Kg
- 2041213 - 5.70Kg
- 2041214 - 5.70Kg
- 2041215 - 5.60Kg
- 2041216 - 7.60Kg
- 2041217 - 5.60Kg
- 2041218 - 7.60Kg
- 2041219 - 5.70Kg
- 2041220 - 7.70Kg
- 2041221 - 5.70Kg
- 2041222 - 7.70Kg
- 2041980 - 5.70Kg (Sensor)
- 2041981 - 5.80Kg (Sensor)

Disconnect from mains supply before replacing the fuse or the lamp.
 Vor dem Einsetzen der Sicherung oder der Lampe Spannungsfreiheit herstellen.
Débrancher le secteur avant de remplacer le fusible ou l'ampoule.
 Desconectar del suministro de la red, antes de realizar la sustitución del fusible o de la lámpara.
Voor het vervangen van lamp of zekering, eerst netspanning uitschakelen.
 Koppla bort spänningen före byte av en säkring eller en lampa.

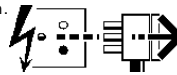

Switch Off
 Abschalten
Débrancher
 Desconectar
Uitschakelen
 Stäng av

stop IS1234 for Air Handling Information!
 IS1236 for Sensor Information!

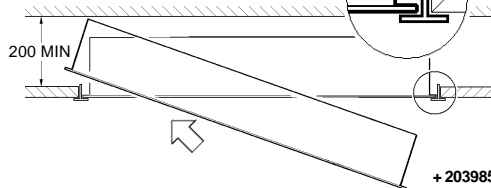
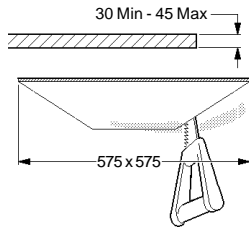

Not suitable for covering with thermally insulating material
 Ne doit pas être recouvert un matériau isolant thermique

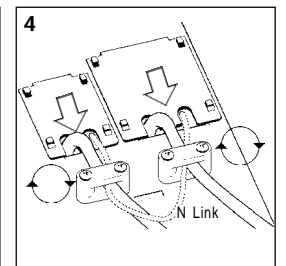
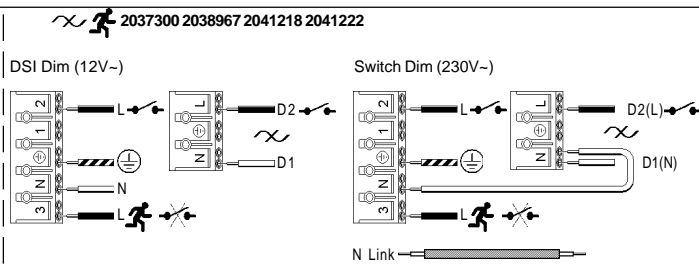
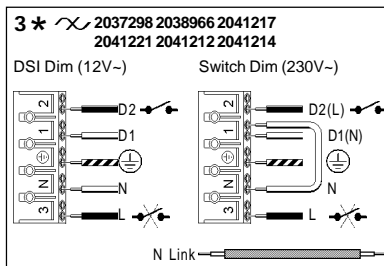
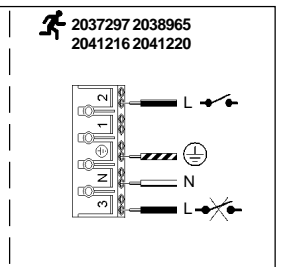
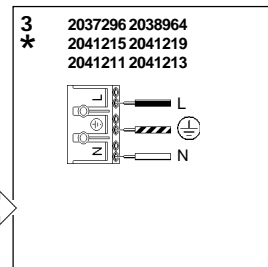
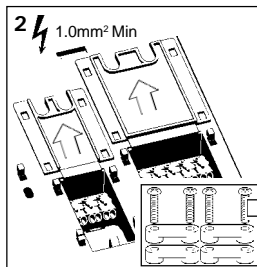
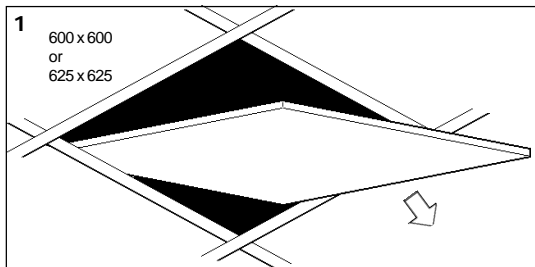
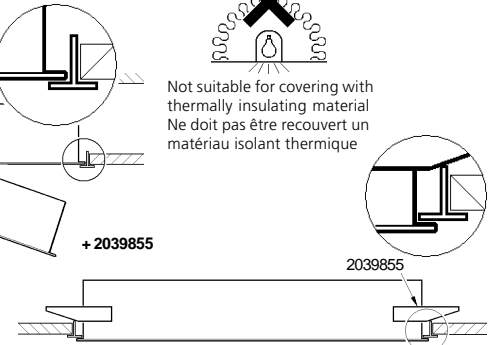

* L = Live N = Neutral ⊕ = Earth ⚡ = Emergency ⚡ = Dimmer D1 = Digital Dimming D2 = Digital Dimming ⚡ = Switched ⚡ = Unswitched

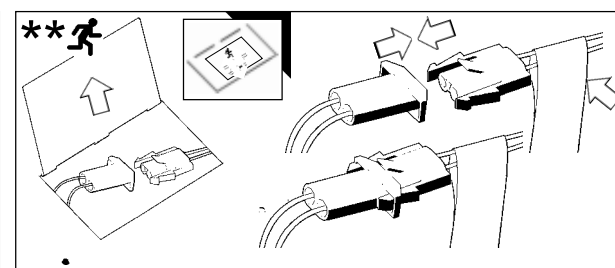
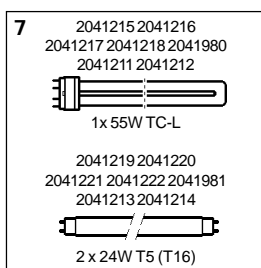
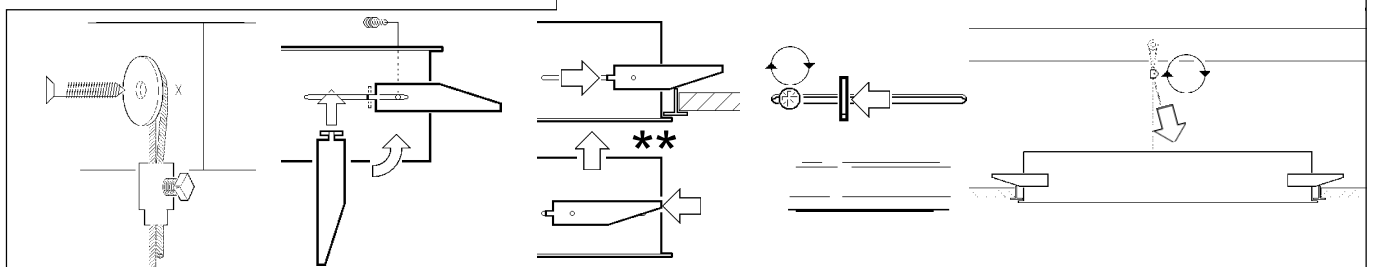
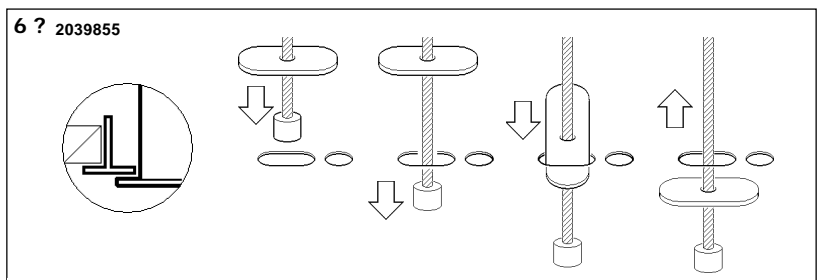
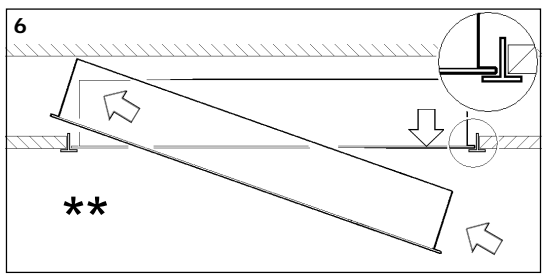

Battery: 6 Cell Ni-Cd/NiMH 4.8V x 4Ah

| | | | | |
|--------------------|------|------|------|------|
| COMMISSIONING DATE | JAN | FEB | MAR | APR |
| | MAY | JUN | JUL | AUG |
| | SEP | OCT | NOV | DEC |
| | 2006 | 2007 | 2008 | 2009 |
| | 2010 | 2011 | 2012 | 2013 |
| | 2014 | 2015 | 2016 | 2017 |

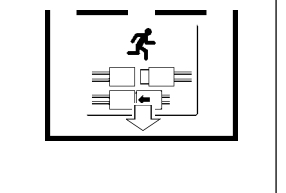

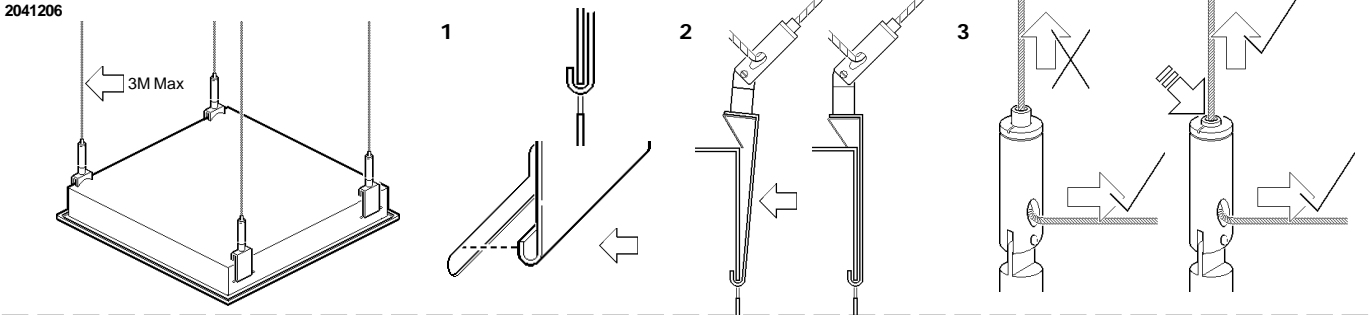
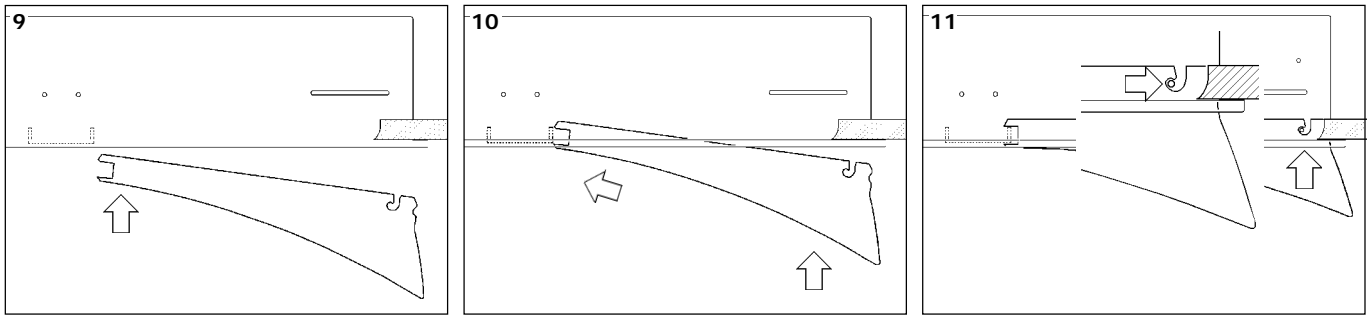

Routine Maintenance

Routine maintenance must be carried out in compliance with the requirements of BS5266:Part 1 - Emergency Lighting of Premises.

The following tests assume a three-hour system.

- Daily:**
1. Check that any recorded faults have been rectified.
 2. Check that the maintained emergency lamp is operative.
 3. Check that the charge indicator light is illuminated.
- Monthly:**
(Functional)
1. Simulate a mains failure and check that the emergency lamp illuminates and remains on for several minutes.
 2. After reverting back to mains supply check the charge indicator light is illuminated.
- Six Monthly:**
(1 Hour)
1. Simulate a mains failure and check that the emergency lamp illuminates and remains on for one hour.
 2. After reverting back to mains supply check the charge indicator light is illuminated.
 3. On restoring the mains supply the unit will require approximately 24 hours to recharge before becoming fully operational.
- Three Years:**
(3 Hours)
1. Simulate a mains failure and check that the emergency lamp illuminates and remains on for at least 3 hours.
 2. After reverting back to mains supply check the charge indicator light is illuminated.
 3. On restoring the mains supply the unit will require approximately 24 hours to recharge before becoming fully operational.

It is recommended that the battery packs and lamps are replaced every 4 years or sooner if the units performance fails to meet the above requirements. To maintain optimum unit performance, only approved replacement battery packs and lamps must be used.

All routine maintenance checks must be recorded on the unit Routine Test Record and must be made available for inspection at all times.

Installation and Commissioning Record

Luminaire Model Ref: _____ Location: _____
 Installed By: _____ Date: _____
 Commissioned by: _____ Date: _____
 (Full Charge and Discharge Cycle)

Routine Test Record

| Monthly Test | First Year | | Second Year | | Third Year | | Forth Year | | Fifth Year | |
|-----------------|------------|-------|-------------|-------|------------|-------|------------|-------|------------|-------|
| | Signed | Dated | Signed | Dated | Signed | Dated | Signed | Dated | Signed | Dated |
| Functional | | | | | | | | | | |
| Functional | | | | | | | | | | |
| Functional | | | | | | | | | | |
| Functional | | | | | | | | | | |
| Functional | | | | | | | | | | |
| 1 Hour Duration | | | | | | | | | | |
| Functional | | | | | | | | | | |
| Functional | | | | | | | | | | |
| Functional | | | | | | | | | | |
| Functional | | | | | | | | | | |
| Functional | | | | | | | | | | |
| 1 Hour Duration | | | | | | | | | | |
| 3 Hour Duration | | | | | | | | | | |

Suitable for use indoors
 Geeignet für Innenanwendung
Pour un usage interne
 Adecuada para uso en interiores
Geschikt voor gebruik binnen
 Lämpig för inomhusbruk



Replace any cracked protective shield.
 Dieses symbol bedeutet, dass defekte schutzgläser sofort ersetzt werden müssen.
Ce symbol indique que vous devez remplacer tout verre de protection fêlé.
 Este simbolo indica que hay que 'reemplazar filtros en caso de rotura o desperfectos'.
Dette symbolet indikerer at alle ødelagte (sprukne) sikkerhetsglass må skiftes.
 Valaisinta el saa käyttää ilman suojalasia vioitunut suojalasi on vaihdettava uuteen ennen valaisimen käyttöön ottoa.

< Millimetres > This Electrical Product MUST be recycled.



Concord

Avis Way Newhaven East Sussex BN9 0ED
 T 0870 606 2030 F 01273 512 688 email: information@concordmarlin.com



© Concord Lighting Ltd.