

Multilite

Installation Instructions for: **STRIPUS S6709 STRIPPC S6710**

2317228 2317229

SAFETY

Follow the appropriate national wiring regulations. If in any doubt contact a qualified Electrician.

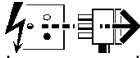

Disconnect from Mains supply before installation, Maintenance or replacing the lamp.

Lamps reach maximum temperatures rapidly. Take care when

adjusting, relamping or cleaning.

The company accepts no responsibility for modified products or for the affects of cleaning solvents or for the accumulation of dust or dirt.

Do not interconnect Class III products with Class I or Class II.

Unless otherwise marked, products are IP20(ordinary). Do not use in Damp or Corrosive situations.

All products are suitable for use in ambient temperatures of 25° C.

The products should not be covered with any heat insulating material, air flow around the fitting should not be restricted. Note minimum distances to adjacent surfaces. Any enclosure which prevents normal heat dissipation may cause reduced performance, overheating or risk of fire. (see Installation Instructions for recommendations).

These products should be connected to the lighting circuit, or fused at a maximum of 5A. If a dimmer is installed it must be specifically rated as suitable for the equipment used.

After completing the installation note the suppliers name, address and purchase date and hand this leaflet to the person responsible for lighting maintenance, for future reference.

Follow these instructions carefully to ensure safe and reliable

operation. Retain this leaflet for future reference. In case of any queries contact your supplier.

The following symbols may be found on the product or labels:



-Class I. This fitting Must be Earthed and Equipotentially bonded.



-This fitting is suitable for mounting on Normally Flammable surfaces.



-Indicates the safest minimum distance of lamp from a flammable surface.



-Class II Double insulated. This fitting must not be Earthed.



-Class III. Low Voltage (SELV).

Throughout these instructions the following coding may be used:

Line (L)	-	Brown or Red.
Neutral (N)	-	Blue or Black.
Earth (⊕)	-	Green/Yellow or Bare Conductor

All Dimensions are in Millimetres

Installation Instructions

- 1 Remove diffuser/end cap by gently levering off with a screwdriver inserted in the slot at one end. Care should be taken not to damage the diffuser/endcap or base. Only the end cap with a slot need be removed.
- 2 Remove the lamp by gently gripping one end and pulling it towards the other end. When the held end is clear of it's lampholder lift it away from the base. Remove any packaging from around the lamp. Fig 3
- 3 Using the fitting as a template mark the fixing positions, ensure they are clear of any sub-surface wiring or obstructions. Fig 4 Drill appropriate fixing holes. Fig 5
- 4 For surface wiring remove appropriate knock-out.
- 5 Strip back outer and inner insulation from the supply cable. Fig 6
ENSURE INSULATING BACK PLATE IS FITTED.
- 6 Wire supply cable into the terminal block taking note of terminal block markings. Ensure there are no exposed conductors or any trapped insulation. Fig 7
- 7 Position fitting and securely fix in place. Ensure that there is no wiring trapped between the fitting and the mounting surface. Fig 8
- 8 Refit the lamp by reversing the procedure in operation 2. Fig 9
- 9 Re-fit diffuser cap by placing in position and pressing into place.
- 10 Switch on the mains supply and check that the fitting is operating correctly.

NOTE: The diffuser or the end caps must be in position in order for the fitting to operate.

On completion of the installation, hand this leaflet to the person responsible for lighting maintenance. Make a note on the leaflet of the supplier and the date of purchase.

Lamp Changing

Defective lamps should be changed as soon as possible; only lamps of the correct type and rating should be used, (see product rating label).

The fitting and lamp can quickly become hot; ensure that both have cooled adequately before adjusting or replacing the lamp.

Switch off from mains supply before starting procedure. For lamp and re-fitting method see Installation Instructions.

Dispose of old lamps in accordance with lamp manufacturers recommendations.

Cleaning

Clean only with a soft dry cloth, having first ensured that the mains supply is disconnected. Do not use abrasives or solvents.



This Electrical Product MUST be recycled.



Fig 1

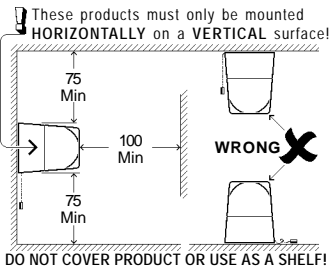

Fig 2

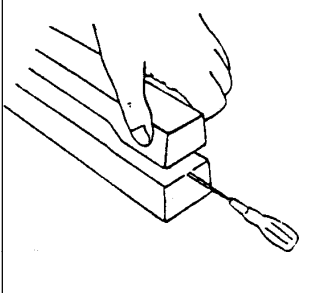

Fig 3

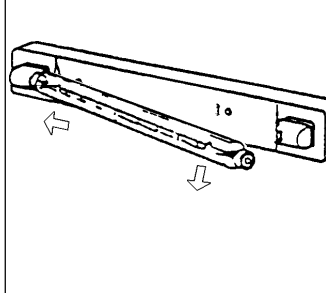

Fig 4

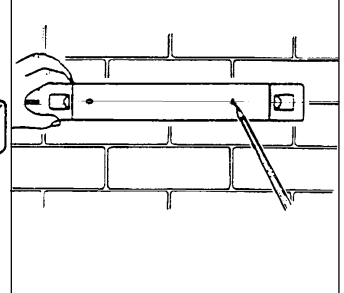

Fig 5

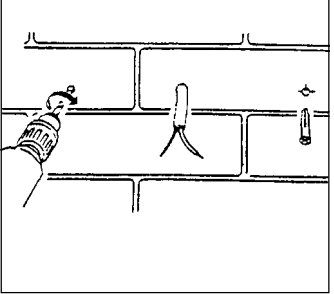

Fig 6

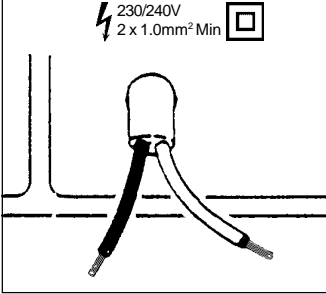

Fig 7

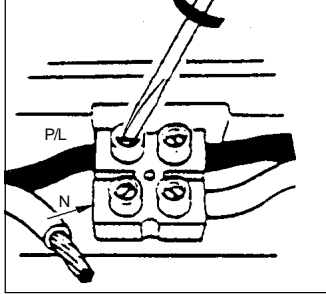

Fig 8

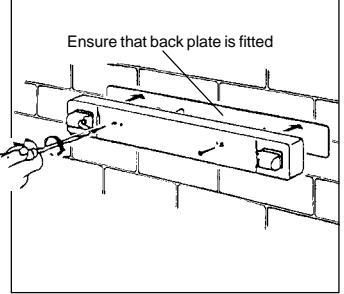

Fig 9

