

Disconnect from mains supply before replacing the fuse or the lamp.
 Vor dem Einsetzen der Sicherung oder der Lampe Spannungsfreiheit herstellen.
Débrancher le secteur avant de remplacer le fusible ou l'ampoule.
 Desconectar del suministro de la red, antes de realizar la sustitución del fusible o de la lámpara.
Voor het vervangen van lamp of zekering, eerst netspanning uitschakelen.
 Koppla bort spänningen före byte av en säkring eller en lampa.

Switch Off
 Abschalten
Débrancher
 Desconectar
Uitschakelen
 Stäng av

Installation Instructions for: 12V IP65 Showerlight
 2425884 2425885 2425886

Important

Please follow these instructions carefully to ensure safe and reliable installation and operation.

Safety

Bathroom Lighting.

For the correct location and wiring of lighting fixtures within bathroom and shower areas, please consult the IEE Wiring Regulations.
 It is recommended that the fitting be installed by a competent electrician in accordance with these instructions and the appropriate local wiring regulations.
 Disconnect from mains supply before installation, maintenance or replacing the lamp. Low Voltage showerlights require a 12V supply and must be connected to a suitable transformer. They must **NOT** be connected direct to a mains supply. To minimise cable size and runs, the transformer should be located as close as possible to the showerlight and in a well ventilated position.
 In certain circumstances you may be required to maintain the fire-rating integrity of the ceiling. If in any doubt please check with your local building inspector.
 All light fittings run hot. It is the installer's responsibility to consider fire risk and take precautions. Any insulation material should be removed from around the fitting and fittings should not be installed close to any flammable material.
 If the showerlight is to be installed into an uneven surface the local area must be smoothed off. In order to achieve full IP65 rating, a suitable bathroom sealant must be used between the gasket of the ceiling ring and the mounting surface.
If this is not done, the IP65 rating cannot be guaranteed.
 12V lamps run hot and should **NOT** be positioned closer than 0.8m to any illuminated surface. Do not interconnect Class III fittings with Class II.
 Only lamps of the correct type should be used - 12V 35W QR-CBC51 GX/GU5.3 (Max). Use eye protection when cutting out the mounting hole.
 We accept no responsibility for modified fittings or for the affects of cleaning solvents or the accumulation of dust or dirt.
 This Instruction Sheet should be passed on by the installer to the end user for maintenance purposes.

Installation and Wiring

Before commencing ensure the void above the cut out hole is free from cables and any obstructions.
 Select required position for showerlight ensuring that the clearances shown are observed and cut a hole 72mm in diameter.
 Switch off mains supply before making any wiring connections.
 Drop lampholder down through the ceiling ring.
 This product should be connected to a 12V SELV Transformer.
 Connect mains supply to the input side of the transformer using suitable cables. Connect 12V secondary cables to the output side of the transformer. Ensure **ALL** electrical connections are tight.
 Using firm pressure separate the lamp housing from the ceiling ring.
 Undo cable clamp and connector box screws. Open lid of connector box and connect incoming 12V secondary cables to terminal block (2.5mm² maximum; if cable size is larger, use a separate junction box to reduce the cable size). Ensure **ALL** electrical connections are tight.
 Close connector box lid and retighten screw. Place incoming 12V secondary cables in cable clamp and retighten screw.
 Fit mounting bracket into prepared slot on the side of the ceiling ring and tighten fixing screw. Apply a suitable bathroom sealant between the gasket of the ceiling ring and the mounting surface (**If this is not done, the IP65 rating cannot be guaranteed**).
 Pull mounting springs up into vertical position and push ceiling ring through ceiling cut out, ensuring silicone gasket is correctly sealed.
 Slide lamp into the lamp housing and locate the two springs as shown.
 Fit lamp into lampholder.
 Push lamp housing onto ceiling ring until it locates and is held in position.
 Switch on the mains supply and check that the fitting is operating correctly.
 To relamp, disconnect from mains supply, remove lamp housing. Replace lamp and refit lamp housing as above

Cleaning

Switch off mains and allow to cool.
 Do not use any abrasive or solvent cleaners.
 Clean with a damp cloth using mild soap if necessary.

F - This fitting is suitable for mounting on normally flammable surfaces.

0.8m - Indicates the safest minimum distance of the lamp from a flammable surface.

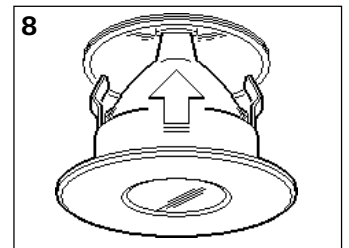
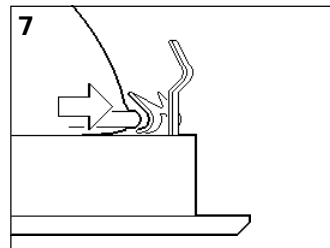
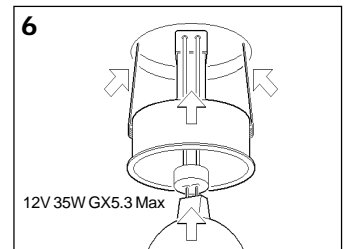
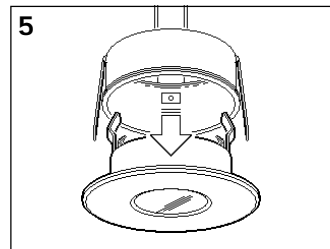
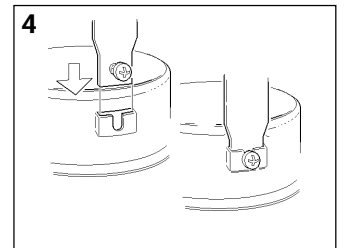
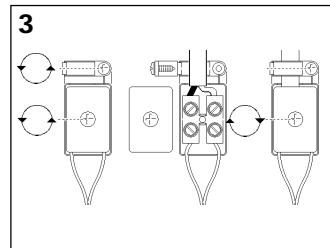
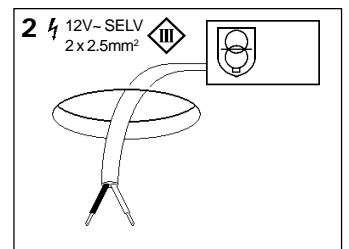
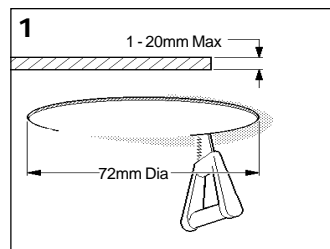
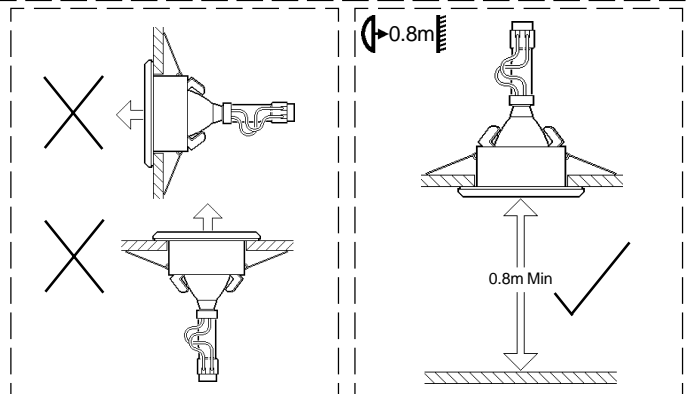
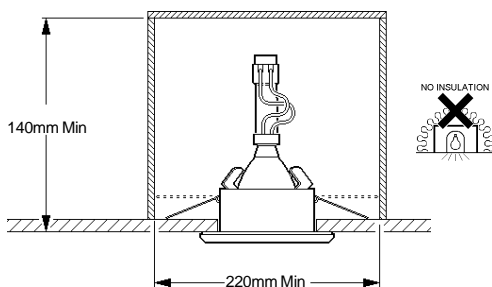

Should you have any queries with this product please contact your local Linolite:SYLVANIA Stockist



This Electrical Product **MUST** be recycled.