

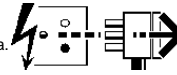

Disconnect from mains supply before replacing the fuse or the lamp.
 Vor dem Einsetzen der Sicherung oder der Lampe Spannungsfreiheit herstellen.
Débrancher le secteur avant de remplacer le fusible ou l'ampoule.
 Desconectar del suministro de la red, antes de realizar la sustitución del fusible o de la lámpara.
Voor het vervangen van lamp of zekering, eerst netspanning uitschakelen.
 Koppla bort spänningen före byte av en säkring eller en lampa.

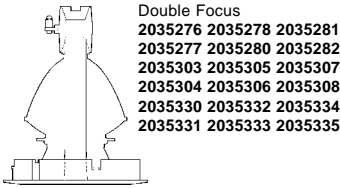

Switch Off
 Abschalten
Débrancher
 Desconectar
Uitschakelen
 Stäng av



Double Focus
 2035276 2035278 2035281
 2035277 2035280 2035282
 2035303 2035305 2035307
 2035304 2035306 2035308
 2035330 2035332 2035334
 2035331 2035333 2035335

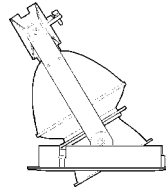

Double Focus Tilt
 2035283 2035285 2035287
 2035284 2035286 2035288
 2035310 2035312 2035314
 2035311 2035313 2035315
 2035336 2035338 2035341
 2035337 2035340 2035342

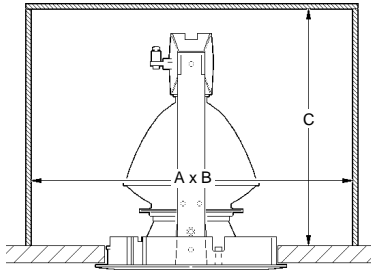

NO INSULATION

 A = 500
 B = 350
 C = 245

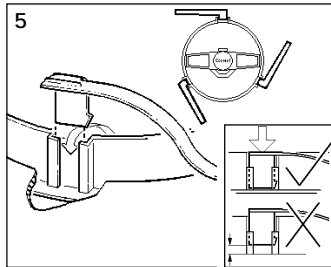
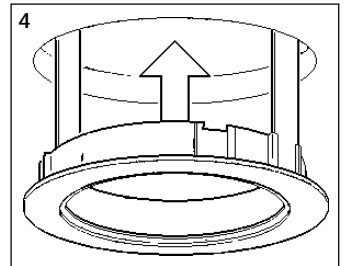
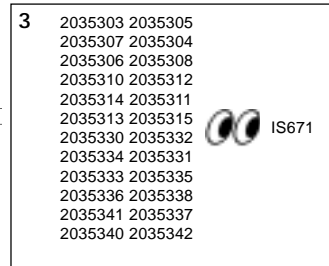
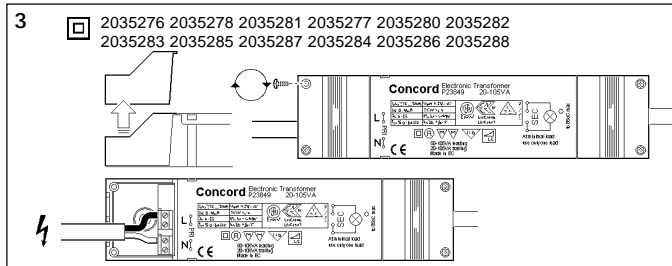
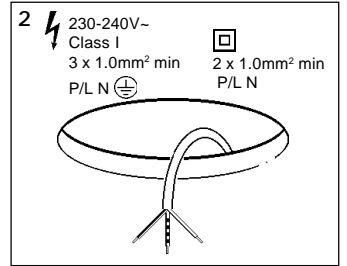
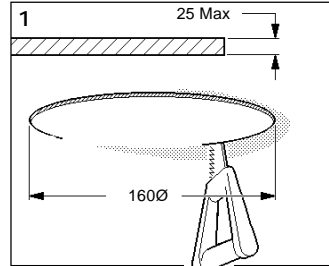

12V 100W Max QT-ax GY6.35
 2035276 2035278 2035281 2035277
 2035280 2035282 2035283 2035285
 2035287 2035284 2035286 2035288

35W Max CDM-T G12
 2035303 2035305 2035307 2035304
 2035306 2035308 2035310 2035312
 2035314 2035311 2035313 2035315

70W Max CDM-T G12
 2035330 2035332 2035334 2035331
 2035333 2035335 2035336 2035338
 2035341 2035337 2035340 2035342

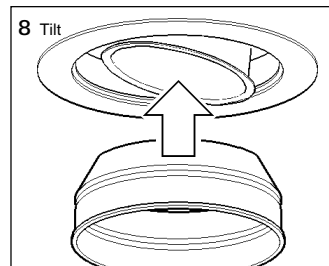
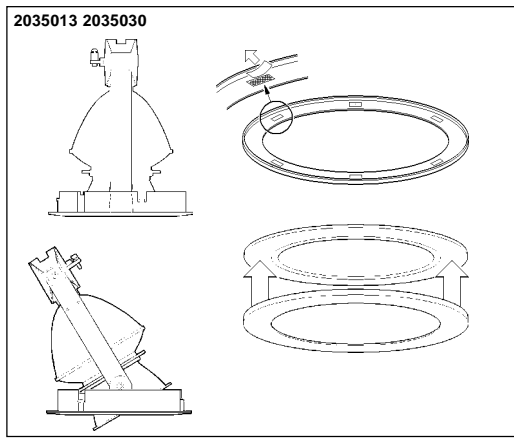
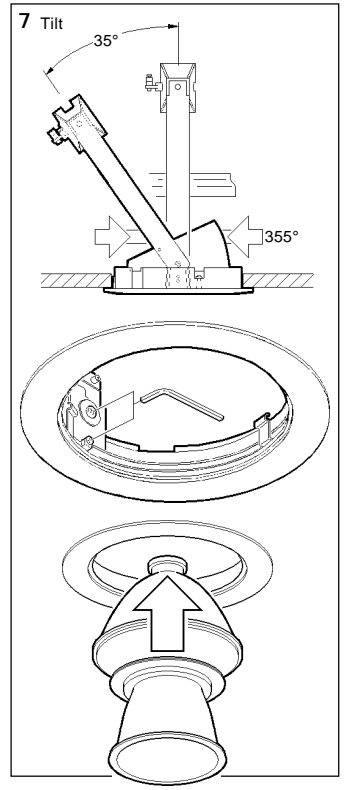
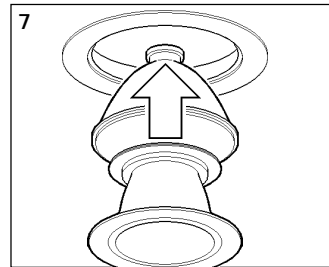

Suitable for use indoors
 Geeignet für Innenanwendung
Pour un usage interne
 Adecuada para uso en interiores
Geschild voor gebruik binnen
 Lämplig för inomhusbruk

Replace any cracked protective shield.
 Dieses symbol bedeutet, dass defekte Schutzgläser sofort ersetzt werden müssen.
Ce symbol indique que vous devez remplacer tout verre de protection fêlé.
 Este simbolo indica que hay que reemplazar al filtro en caso de rotura o desperfectos.
Dette symbolet indikerer at alle ødelagte (sprukne) sikkerhetglass må skiftes.
 Valaisinta ei saa käyttää ilman suojalasia vioitunut suojalasi on vaihdettava uuteen ennen valaisimen käyttöön ottoa.

< Millimetres > This Electrical Product MUST be recycled.

