

AQUARIUS MAXI

Linolite

INSTALLATION INSTRUCTIONS FOR:





Aquarius Maxi Aquarius Maxi
Opal Prismatic

This fitting is suitable for universal mounting.

Follow these instructions carefully to ensure safe and reliable operation.

Retain this leaflet for future reference. In case of query contact your supplier.

The following symbols will be found on the product or labels:

-  — Class 2 Double insulated. This fitting must not be earthed.
-  — Suitable for mounting on normally flammable surfaces.
-  — Dust-proof  — IP64 Splash proof
- N** — Neutral
- L** — Line

COLOUR CODING OF CABLES

Throughout this leaflet the following coding is used:-

- LINE (L) — Brown or Red
NEUTRAL (N) — Blue or Black

SAFETY

Follow the appropriate national wiring regulations; if in doubt consult a qualified electrician.

Disconnect the mains supply before installation, maintenance or replacing the lamp.

This product must not be modified. Any modification will negate any Safety Mark approvals and may render the product unsafe. The Company accepts no responsibility for modified products. These products must be installed in accordance with these instructions.

Suitable for use in ambient temperatures of up to 25°C.

This fitting should not be covered with any heat insulating material and the air flow around it should not be restricted. Note any minimum recess depths or distances to adjacent surfaces.

This unit should be connected to the lighting supply circuit or be fused at a maximum of 5 amps.

To ensure good electrical contact, terminals must be screwed firmly and wire strands must not be tinned.

INSTALLATION

1. Fixing kit included (Fig 1).
2. Remove the diffuser by placing the plucker into the available slot and levering upwards (Fig 2).
- 3a. Unscrew the cover plate for either lamp A, B or C (Fig 3) and lift off.
- 3b. For the fitting which houses lamp B & C, unscrew the lamp moulding screws, slide the lamp moulding forward and remove (Fig 3).

SURFACE MOUNT A

4. Remove appropriate knockout (Fig 4).
5. Using the fitting as a template, mark the fixing positions on the mounting surface, if mounting on the wall, place the fitting so that 'TOP' is at the top. Ensure that they are clear of any sub-surface wiring or obstructions (Fig 5). Drill appropriate holes.
6. Feed mains supply cable through the knockout and into the fitting.

7. Position the fitting and securely fix in place (with Fig 1, parts d & e), ensuring that no cable is trapped between the fitting and the mounting surface.
Go to 13.

SURFACE MOUNT B (Using junction box)

8. Remove appropriate knockout(s).
9. Push the main supply cable through the grommet (fig 1, part a). Mount the fitting onto the box and fix securely with two screws (not supplied) (Fig 6). If mounted on the wall position the fitting so that 'TOP' is at the top. Go to 13.

RECESS MOUNT

10. Mark and cut a hole in the mounting surface with 142mm radius (Fig 7).
11. Fit the brackets loosely to the fitting, using the screws provided (Fig 1 part c), through the appropriate holes (Fig 8a).
12. Feed mains supply cable into the fitting, place fitting into the mounting space and tighten the screws until fitting is firmly held.
Do not overtighten as this may distort the fitting (Fig 8b).
13. Slide the two pieces of silicon sleeving (Fig 1 part b) over the supply cable (Fig 9a). If a splash proof cable entry is required use grommet supplied (Fig 1 part a, Fig 9b).
14. Wire supply cable into terminal block taking note of terminal block markings and cable colour coding (Fig 10).
15. If lampholder moulding has been removed replace by reversing procedure 3.
16. Replace cover plate by reversing the procedure in note 3 (Fig 11).
17. Refit correct lamp (see lamp changing).
18. Refit diffuser.
Reconnect mains supply and check that fitting is operating correctly.

On completion of this installation, hand this leaflet to the person responsible for lighting maintenance. Make a note of the supplier and date of purchase.

LAMP CHANGING

Defective lamps should be replaced as soon as possible, only lamps of correct type and rating should be used (see product rating label).

The fitting and lamp can quickly become hot. Ensure that both have cooled adequately before adjusting or replacing lamps.

Disconnect from mains supply before starting procedure:

- i Lamp A - to fit the lamp, screw in clockwise. For removal of lamp reverse the procedure.
 - ii Lamp B - to fit the lamp press into its holder, remove by gently pulling out and away from lampholder.
 - iii Lamp C - to fit lamps push them into the lampholders until they click into position. To remove, grip in the middle and pull out from lampholder.
- Dispose of old lamp in accordance with lamp manufacturer's recommendations.

CLEANING

Ensure mains supply is disconnected and that fitting and lamp are cool. Use only a soft, dry cloth. Do not use abrasives or solvents.

Note: Do not cover or place any item on this product.

Fig. 1

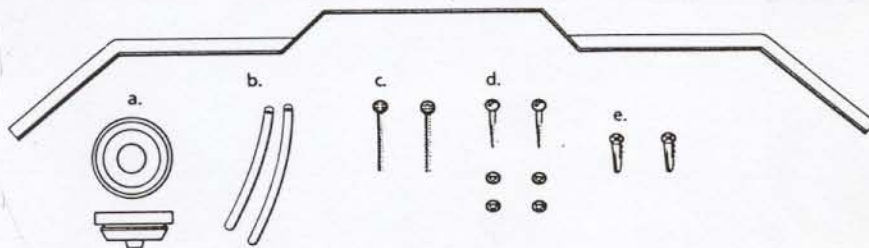
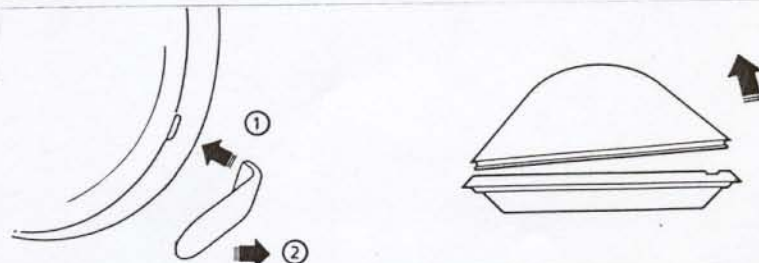
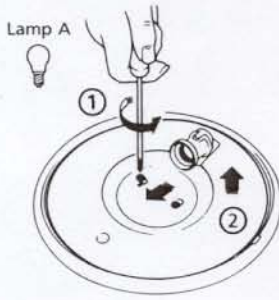

Fig. 2



SLI Lighting, Otley Road, Charlestown, Shipley, West Yorkshire, England BD17 7SN
Tel: (0274) 595921 Fax: (0274) 597683 Telex: 51251

Fig.3



Lamp B

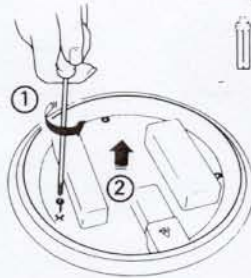

Lamp C

Lamp B

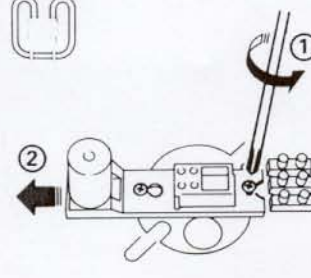

Fig.4

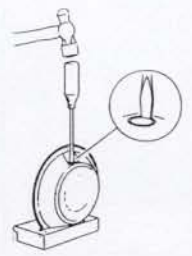

Fig.5

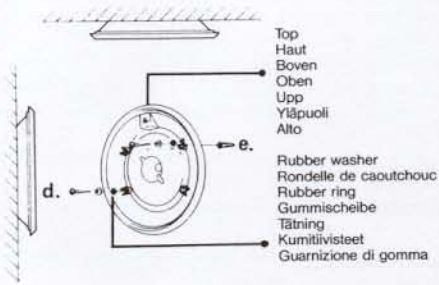

Fig.6

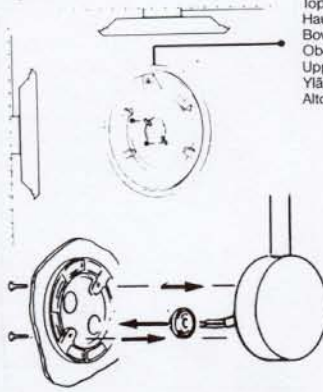

Fig.7

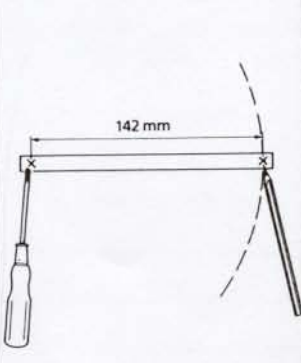

Fig.8a

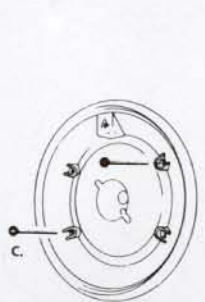

Fig.8b

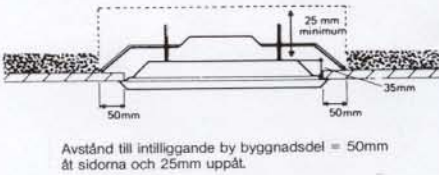

Fig.9a

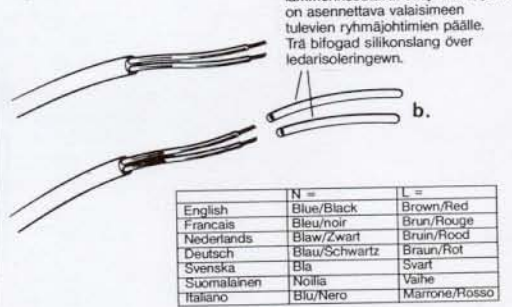

Fig.9b

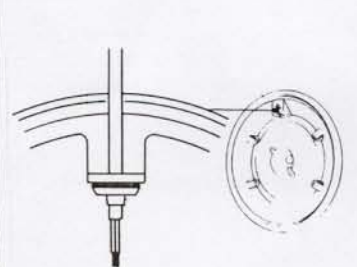

Fig.10

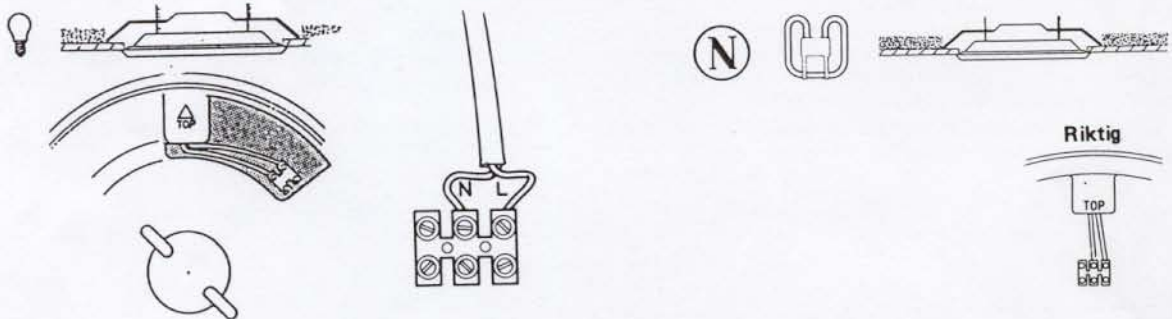
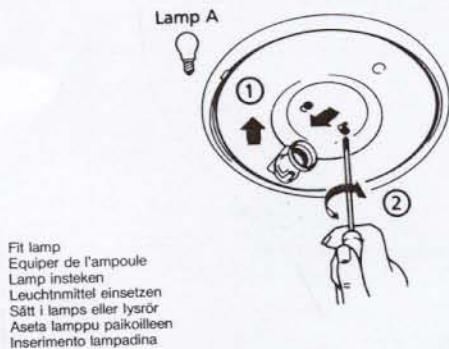
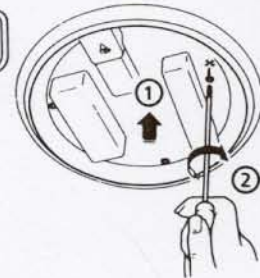

Fig.11



Lamp B



Lamp C

Fit lamp
Equiper de l'ampoule
Lamp insteken
Leuchtmittel einsetzen
Sätt i lamps eller lysrör
Aseta lamppu paikoilleen
Inserimento lampadina