

Disconnect from mains supply before replacing the fuse or the lamp.
 Vor dem Einsetzen der Sicherung oder der Lampe Spannungsfreiheit herstellen.
Débrancher le secteur avant de remplacer le fusible ou l'ampoule.
 Desconectar del suministro de la red, antes de realizar la sustitución del fusible o de la lámpara.
Voor het vervangen van lamp of zekering, eerst netspanning uitschakelen.
 Koppla bort spänningen före byte av en säkring eller en lampa.

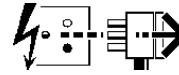

Switch Off
 Abschalten
Débrancher
 Desconectar
Uitschakelen
 Stäng av

This luminaire is suitable for wall or ceiling mounting in interior situations and can be semi-recessed using a Recessing Kit.

Installation should be carried out by a suitably qualified person in accordance with good electrical practice and the appropriate national wiring regulations.

Switch off mains electrical supply before commencing installation.

Installation Procedure

Carefully lever out diffuser (G) from gallery (H).

Check that rating marked on label (J) conforms with mains electrical supply.

Partially screw suitable M4 screws into a conduit box or alternatively prepare suitable fixings in mounting surface using outrigger slots (A&F).

Pass mains supply leads through gallery (H) and secure gallery to conduit box or mounting surface as applicable.

NOTE: Gallery (H) is marked 'TOP' for wall mounting.

Cover supply leads and earth lead with silicone sleeves (E) supplied and connect leads in terminal block (D).

Fit appropriate lamps as shown on label (J) by pushing firmly into lampholders (B) and support clips (I).

Ease diffuser (G) into gallery rim ensuring it is held concentrically by retaining clips (C).

WARNING: This luminaire must be earthed.

NOTE: This luminaire should be cleaned using warm soapy water and a soft cloth. Ensure that luminaire is switched off during cleaning.

Dispose of lamps in accordance with the manufacturer's instructions.

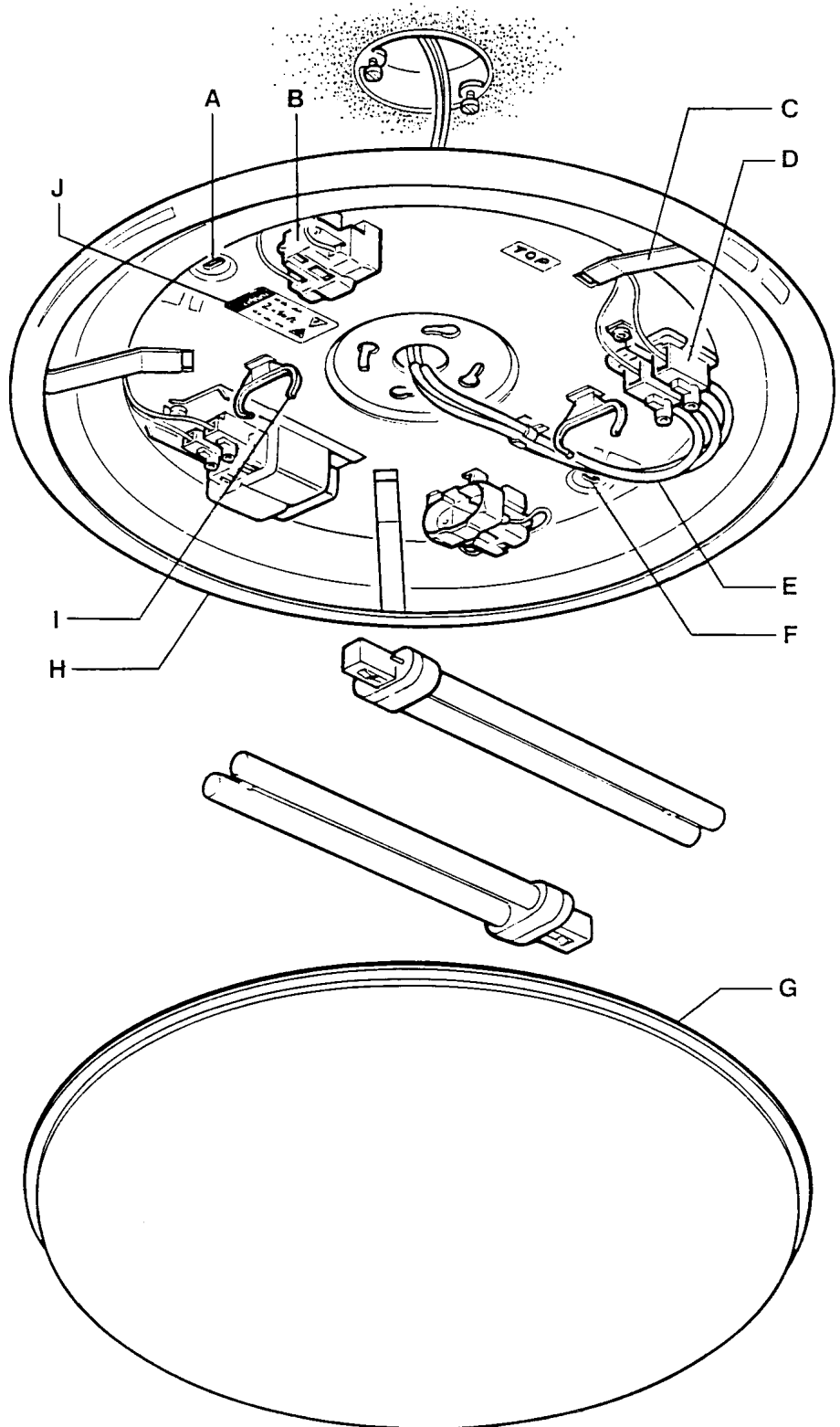

Suitable for use indoors

Geeignet für Innenanwendung

Pour un usage interne

Adecuada para uso en interiores

Geschikt voor gebruik binnen

Lämplig för inomhusbruk



Replace any cracked protective shield.

Dieses symbol bedeutet, dass defekte Schutzgläser sofort ersetzt werden müssen.

Ce symbole indique que vous devez remplacer tout verre de protection fêlé.

Este símbolo indica que hay que reemplazar filtros en caso de rotura o desperfectos.

Dette symbolet indikerer at alle ødelagte (sprukne) sikkerhetglass må skiftes.

Valaisinta ei saa käyttää ilman suoja-alasia vioittunut suoja-lasi on vaihdettava uuteen ennen valaisimen käyttöön ottoa.

< Millimetres >



This Electrical Product
MUST be recycled.



04.08

Concord