

Disconnect from mains supply before replacing the fuse or the lamp.
 Vor dem Einsetzen der Sicherung oder der Lampe Spannungsfreiheit herstellen.
Débrancher le secteur avant de remplacer le fusible ou l'ampoule.
 Desconectar del suministro de la red, antes de realizar la sustitución del fusible o de la lámpara.
Voor het vervangen van lamp of zekering, eerst netspanning uitschakelen.
 Koppla bort spänningen före byte av en säkring eller en lampa.

Switch off
 Abschalten
 Débrancher
 Desconectar
 Uitschakelen
 Stäng av

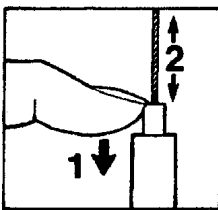
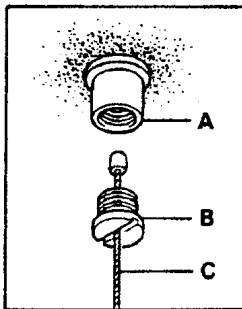
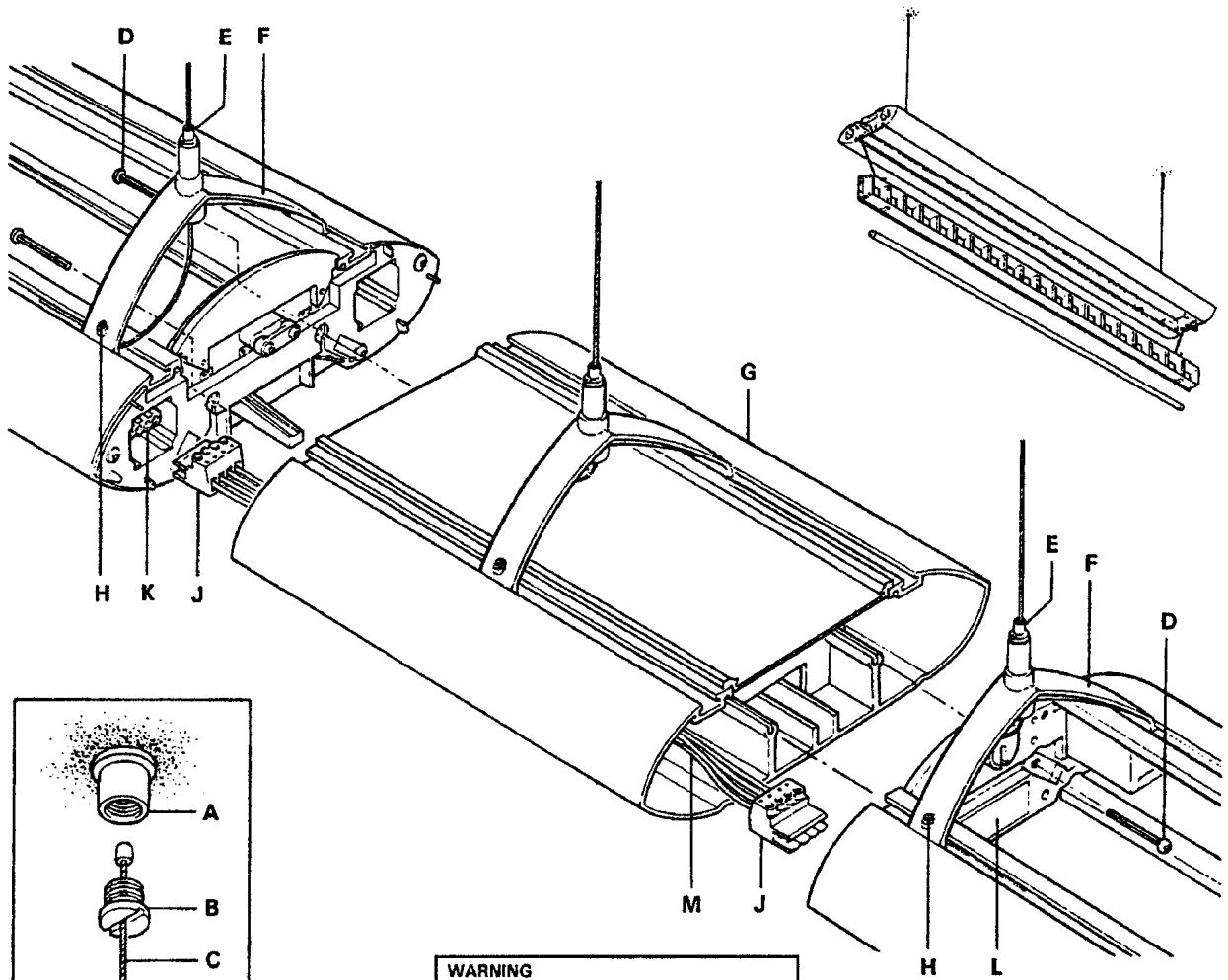

	A	B
28W	1000mm	1206mm
35W	1300mm	1506mm

WARNING
 SWITCH OFF MAINS SUPPLY BEFORE
 DISCONNECTING ELECTRICAL LINK (J)

Installation should be carried out by a suitably qualified person in accordance with good electrical practice and the appropriate national wiring regulations.

Switch off mains electrical supply before commencing installation.

INSTALLATION PROCEDURE

- Secure bosses (A) to mounting surface using suitable fixings. See diagram for suggested fixing centres.
- Pass suspension cables (C) through cable retainers (B) and screw retainers in bosses.
- Slide a suspension yoke (F) into unit channels at each end of unit and gently tighten locking screws (H).
- Pull out reflector and allow it to hang from safety cords and remove lamp/s.
- Check rating on label (L) conforms with mains electrical supply.
- Pass suspension cables (C) through yoke collets (E).

7. **NOTE:** Ensure units are suspended at the correct height and are horizontal. Adjust suspension height by depressing collet button as shown.

8. Connect plugs (J) of unit electrical link in unit sockets (K).

9. **NOTE:** If mains supply is required in the middle of a run, cut and connect link leads (M) into a suitable terminal block.

10. Locate connector (G) between units, and push units to engage.

11. **NOTE:** Connectors over 800mm long must be supported with a yoke and suspension cable.

12. Secure units and connector using supplied fixing screws (D).

13. Fit end caps, lamps and reflectors as shown in Installation Leaflet 0165-5609.

14. Suspension cables must be vertical and unit must be horizontal.

15. Route excess suspension cable along unit channel as shown.

Suitable for use indoors
 Geeignet für innenanwendung
 Pour un usage interne

Adecuada para uso en interiores
 Geschikt voor gebruik binnen
 Lämpflig för inomhusbruk

This Electrical Product MUST be recycled.

