

# Hi-Spot 50/63 Track Pack

**F** This Product **MUST** be **EARTHED**

# SYLVANIA

Instruction Sheet  
No. IS 643A

2629280  
2629281  
2629282  
2629283



**Disconnect from mains supply before replacing the fuse or the lamp.**  
**Vor dem Einsetzen der Sicherung oder der Lampe Spannungsfreiheit herstellen.**  
**Débrancher le secteur avant de remplacer le fusible ou l'ampoule.**  
**Desconectar del suministro de la red, antes de realizar la sustitución del fusible o de la lámpara.**  
**Voor het vervangen van lamp of zekering, eerst netspanning uitschakelen.**  
**Koppla bort spänningen före byte av en säkring eller en lampa.**

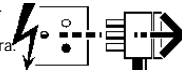

**Switch Off**  
**Abschalten**  
**Débrancher**  
**Desconectar**  
**Uitschakelen**  
**Stäng av**

2629280 2629281 2629282 2629283

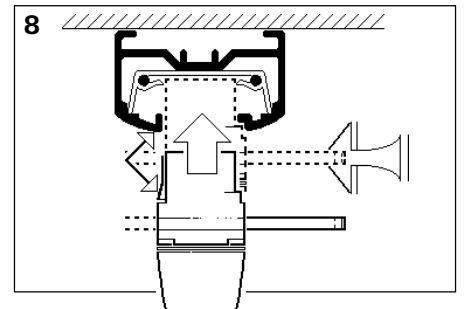
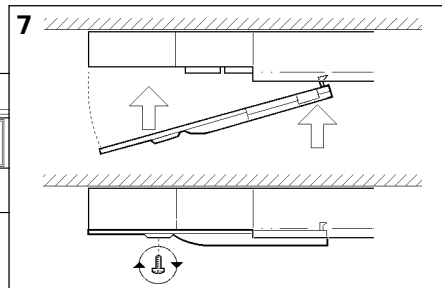
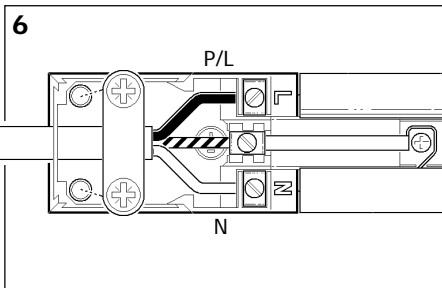
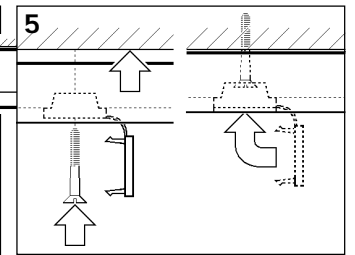
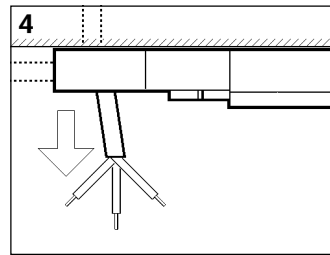
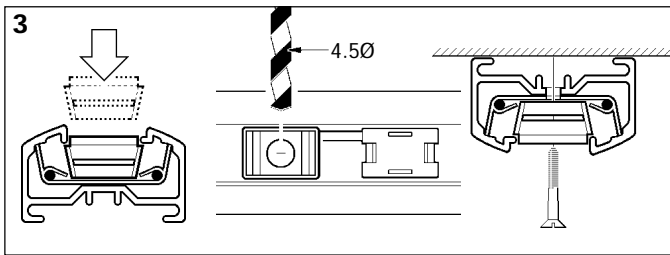
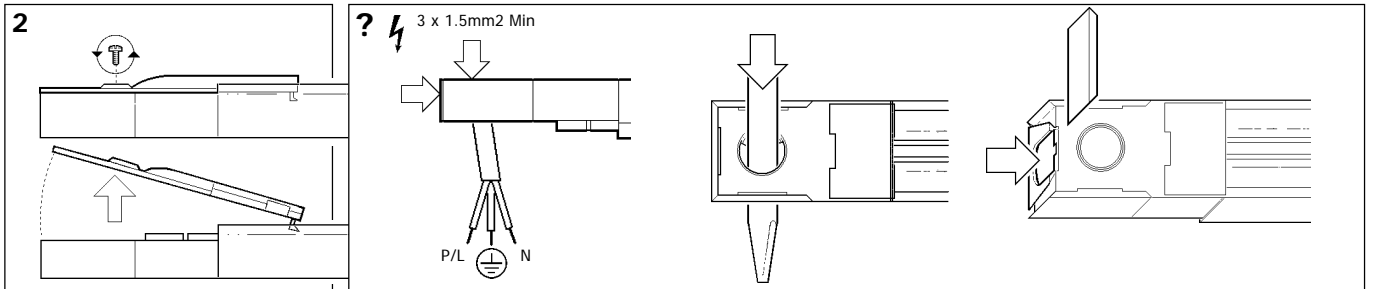
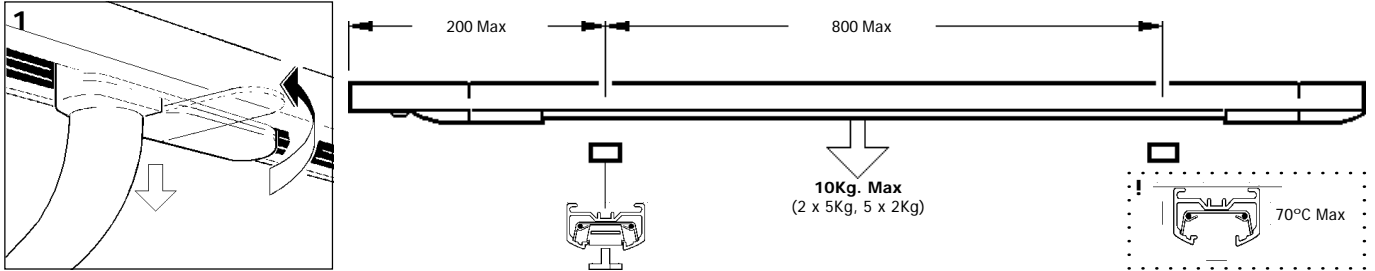

2629280 2629281

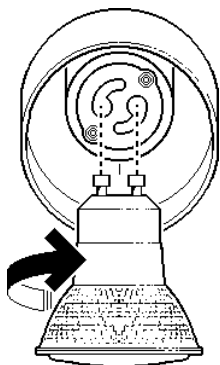

50W Max Hi-Spot ES50 GU10

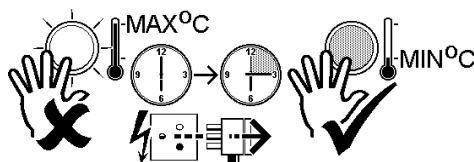
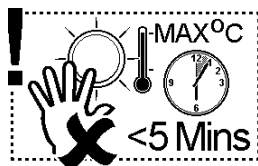

**Suitable for use indoors**  
**Geegnet für Innenanwendung**  
**Pour un usage interne**  
**Adecuada para uso en interiores**  
**Geschikt voor gebruik binnen**  
**Lämplig för inomhusbruk**



←Millimetres→