

Torus 50FX Recessed



IS718E

2033460 - LO 2033461 - IP
 2033462 - LO 2033463 - IP
 2033464 - LO 2033465 - IP

NO INSULATION



Disconnect from mains supply before replacing the fuse or the lamp.
 Vor dem Einsetzen der Sicherung oder der Lampe Spannungsfreiheit herstellen.
Débrancher le secteur avant de remplacer le fusible ou l'ampoule.
 Desconectar del suministro de la red, antes de realizar la sustitución del fusible o de la lámpara.
Voor het vervangen van lamp of zekering, eerst netspanning uitschakelen.
 Koppla bort spänningen före byte av en säkring eller en lampa.

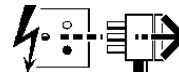

Switch Off
 Abschalten
Couper le conector
 Desconectar
Uitschakelen
 Stäng av

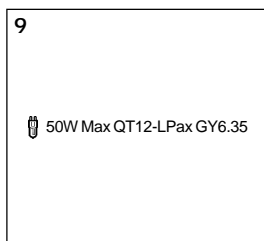
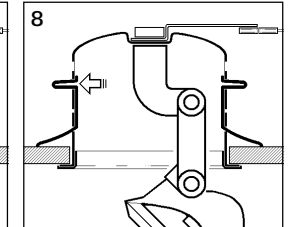
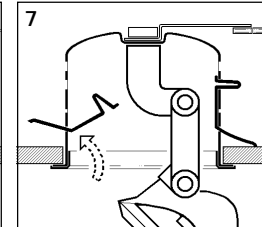
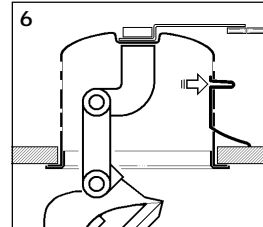
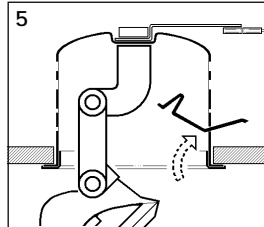
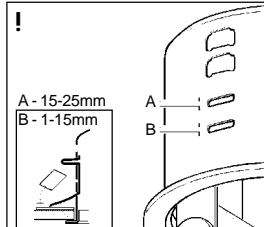
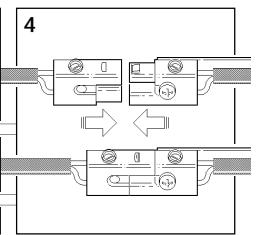
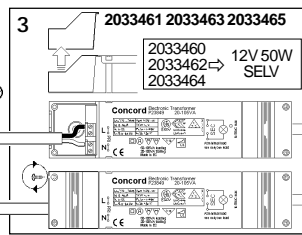
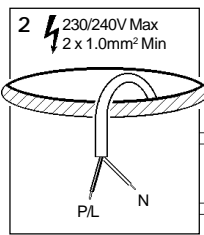
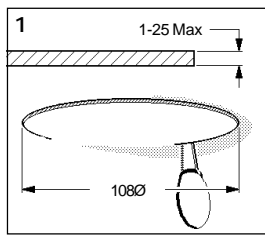
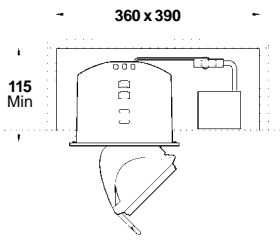

Accessories Optional Safety Lens Assemblies

2030818 Spot

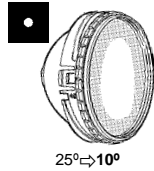

25° ⇒ 10°

2030820 Elongation



10°/25° ⇒ 3:1

2030821 Wide Flood



10°/25° ⇒ 42°

2030822 Flood

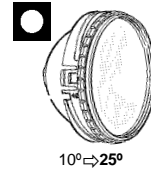

10° ⇒ 25°

2032777 Low Glare

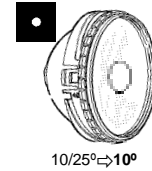

10°/25° ⇒ 10°

2032778 Extra Wide Flood

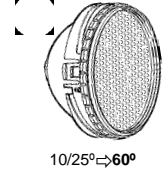

10°/25° ⇒ 60°

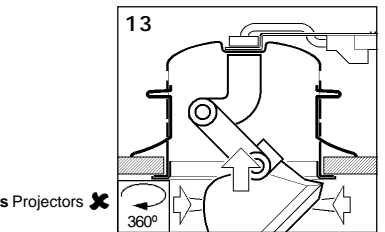
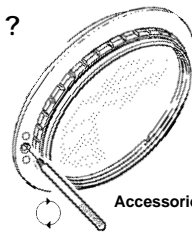
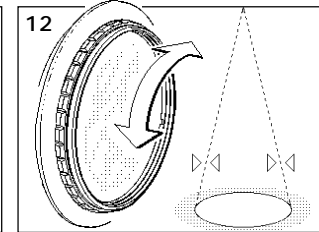
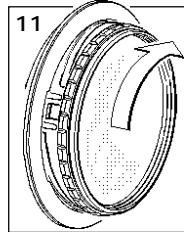
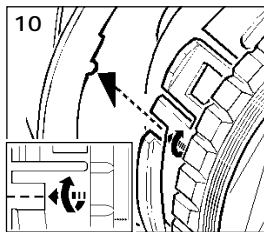

Accessories Projectors ✗

Accessories Additional Filters

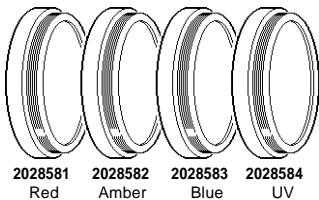

2028581 Red
 2028582 Amber
 2028583 Blue
 2028584 UV

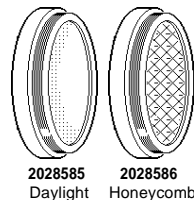

2028585 Daylight
 2028586 Honeycomb

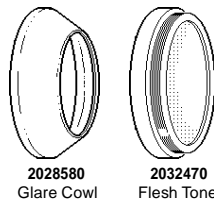

2028580 Glare Cowl
 2032470 Flesh Tone

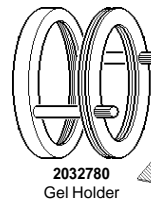

2032780 Gel Holder

Rosco - Supergel 4% Minimum Polycarbonate Tri-extruded Filters
www.rosco-ca.com/uk/

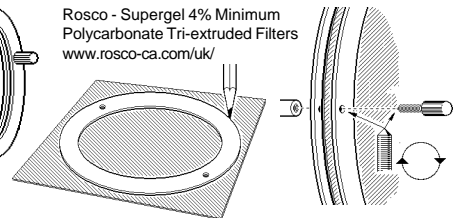

2028581 2028582 2028583 2028584
 2028585 2028586 2032470 2032780

2028580

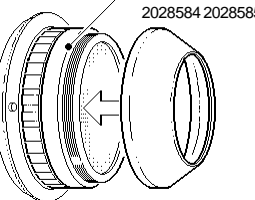
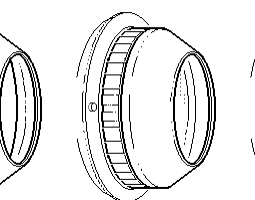
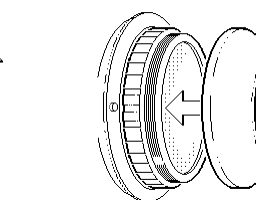
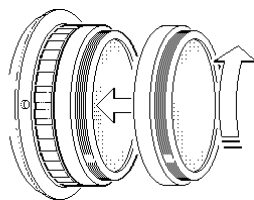
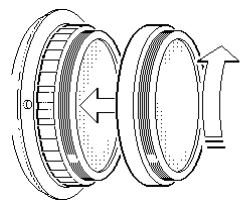

2028581 2028582 2028583
 2028584 2028585 2032470

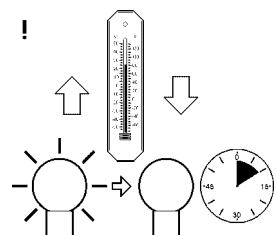

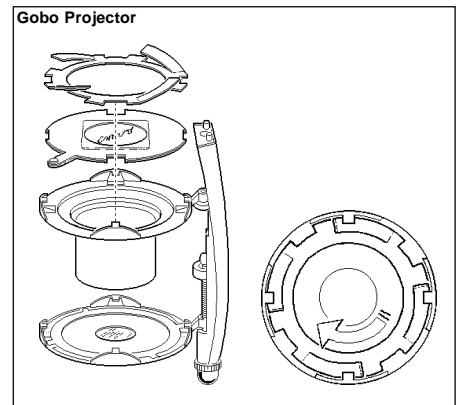
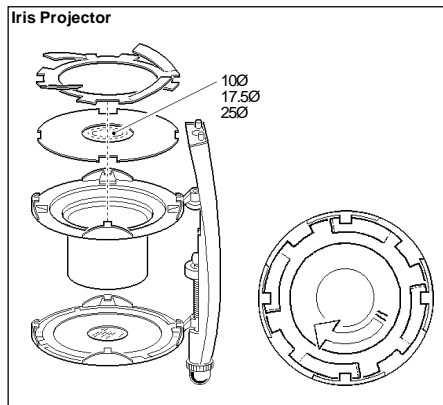
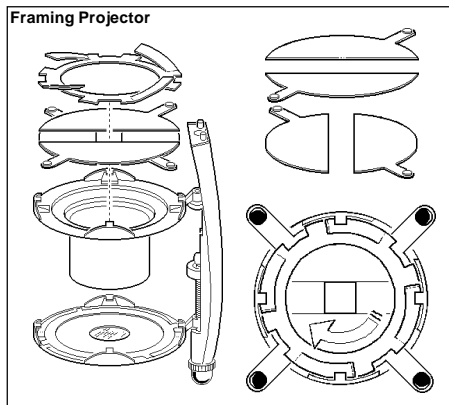
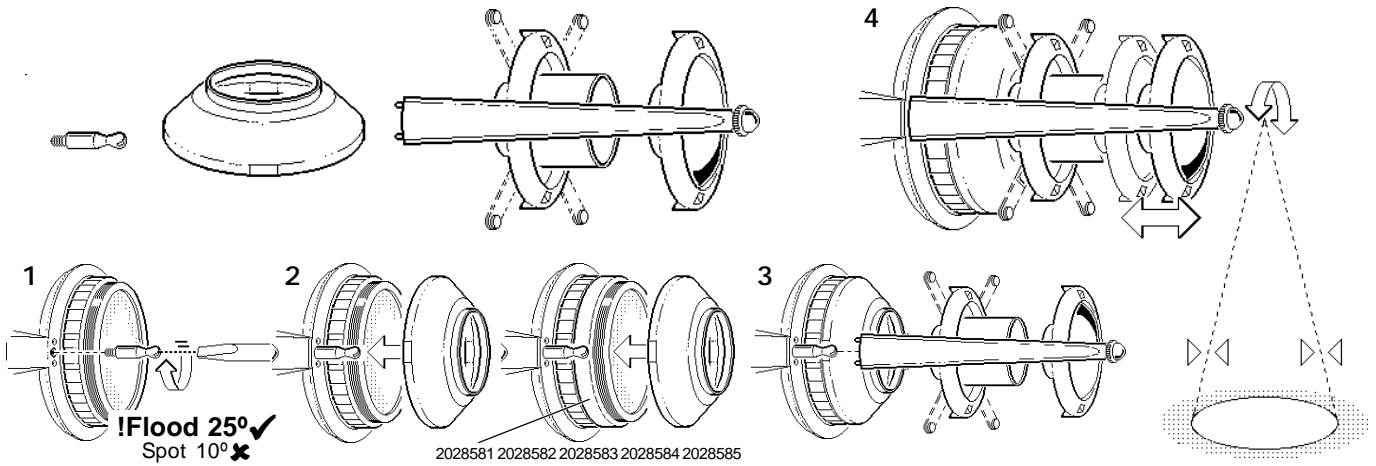

	2034704	2028580	2028581	2028582	2028583	2032470	2028584	2028585	2028586	2032780	2030818	2030820	2030821	2030822	2032777	2032778	2028588,9,90	2028591,2,3	2028594,5,6
Barn Doors		✓	✓	✓	✓	✓	✓	✓	✓	✓	✓	✓	✓	✓	✓	✓	✓	✓	✓
Glare Cowl		✓	✓	✓	✓	✓	✓	✓	✓	✓	✓	✓	✓	✓	✓	✓	✓	✓	✓
Red Filter	✓	✓																	
Amber Filter	✓	✓																	
Blue Filter	✓	✓																	
Flesh Tone	✓	✓																	
UV Filter	✓	✓																	
Daylight Filter	✓	✓																	
Honeycomb Filter						✓	✓	✓	✓	✓	✓	✓	✓	✓	✓	✓	✓	✓	✓
Gel Holder										✓	✓	✓	✓	✓	✓	✓	✓	✓	✓
Spot Lens	✓	✓	✓	✓	✓	✓	✓	✓	✓	✓	✓	✓	✓	✓	✓	✓	✓	✓	✓
Elongation Lens	✓	✓	✓	✓	✓	✓	✓	✓	✓	✓	✓	✓	✓	✓	✓	✓	✓	✓	✓
Wide Flood Lens	✓	✓	✓	✓	✓	✓	✓	✓	✓	✓	✓	✓	✓	✓	✓	✓	✓	✓	✓
Flood Lens	✓	✓	✓	✓	✓	✓	✓	✓	✓	✓	✓	✓	✓	✓	✓	✓	✓	✓	✓
Low Glare Spot Lens	✓	✓	✓	✓	✓	✓	✓	✓	✓	✓	✓	✓	✓	✓	✓	✓	✓	✓	✓
Extra Wide Flood Lens	✓	✓	✓	✓	✓	✓	✓	✓	✓	✓	✓	✓	✓	✓	✓	✓	✓	✓	✓
Framing Head																	✓		
Iris Head																		✓	
Gobo Holder																			✓

Glass: 25mm x 25mm

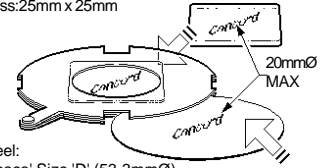

Steel: 'Rosco' Size 'D' (53.3mmØ) or 'Rosco' Size 'E' (37.5mmØ) or 'Datasights'

These products are protected by the following:
Trade Marks UK 2107975 CTM 000339200 Design Registrations UK 2061204 International DM 039453

+ Replace any cracked protective shield.
Dieses symbol bedeutet, dass defekte Schutzgläser sofort ersetzt werden müssen.
Ce symbol indique que vous devez remplacer tout verre de protection fêlé.
Este simbolo indica que hay que reemplazar filtros en caso de rotura o desperfectos.
Dette symbolt indikerer at alle ødelagte (sprukne) sikkerhetsglass må skiftes.
Valaisinta el saa käyttää ilman suojaosia vioittunut suojaosi on vaihdettava uuteen ennen valaisimen käyttöön ottoa.

< Millimetres >

This Electrical Product MUST be recycled.

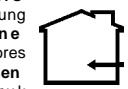

07.08